

ITEM NO.	PART NUMBER	DESCRIPTION	QTY.
1	522004	DUAL VOLTAGE CONVECTION FAN MOTOR (INCLUDES ITEM #7, #9 & #10)	1
2	532004	8" FAN BLADE CW SS 1/2" HUB	1
3	532010	10" FAN BLADE CW SS 1/2" HUB (MLR-850 ONLY)	1
4	532004	8" FAN BLADE CW SS 1/2" HUB (MLR-150 ONLY)	1
5	591009	FAN BRACKET ASSEMBLY	1
6	591016	FAN BRACKET ASSEMBLY (MIRROR IMAGE)	1
7	533001	FAN DISK HEAT SINK 5/8" SHAFT	1
8	800011	STANDOFF 1/4-20 M/F THREAD	4
9	523001	MOTOR BUSHING (NOT SHOWN)	2
10	523002	MOTOR MOUNTING BASE	1

HUB FACES AWAY FROM MOTOR
AND HUB IS FLUSH WITH END OF SHAFT.

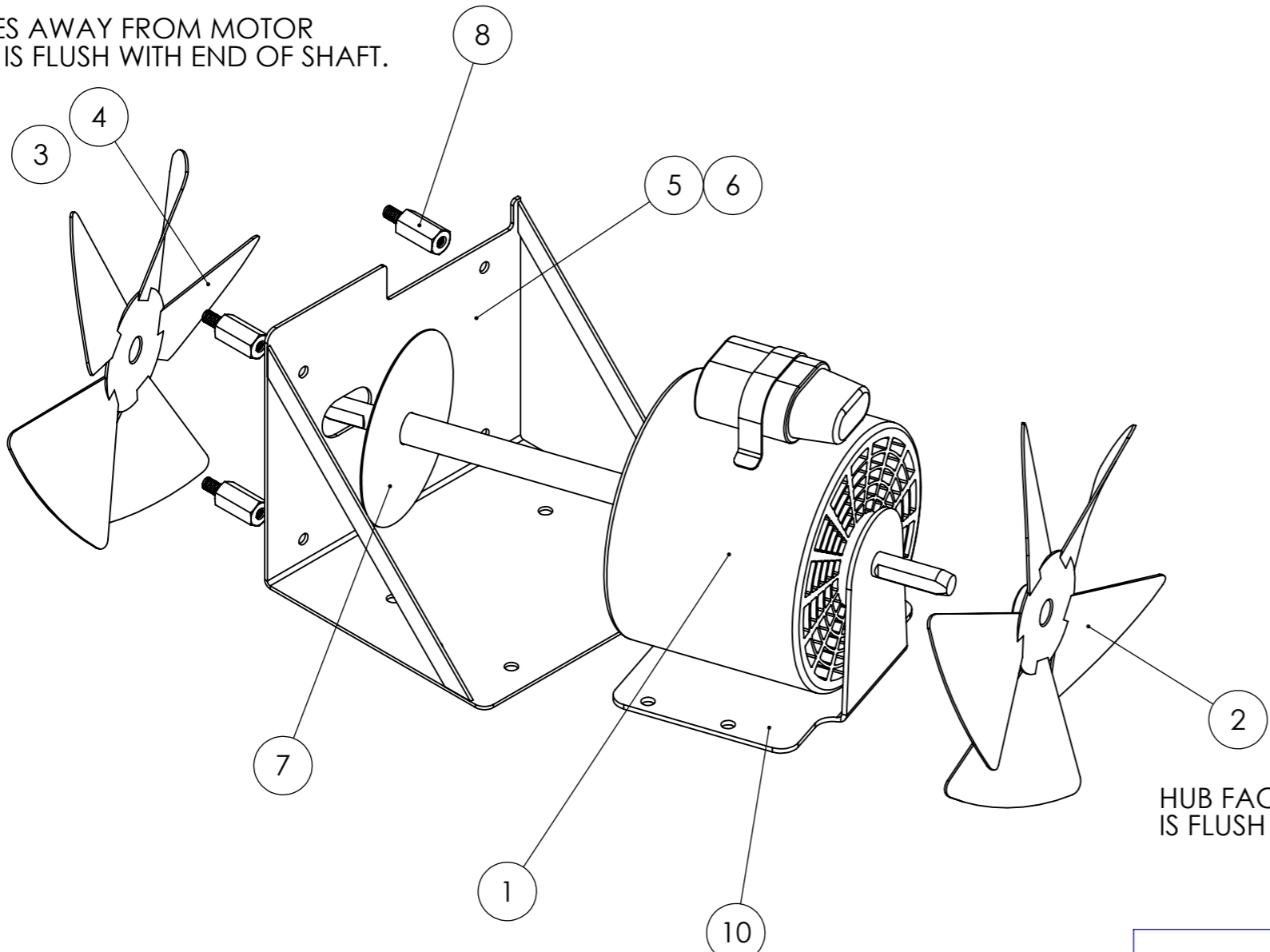

HUB FACES MOTOR AND BLADE
IS FLUSH WITH END OF SHAFT.

REFER TO SERVICE BULLETIN SP2017-002 FOR SET SCREW AND ALLEN WRENCH SIZES.
SET SCREWS SHOULD BE TIGHTENED ON FLAT OF MOTOR SHAFT.

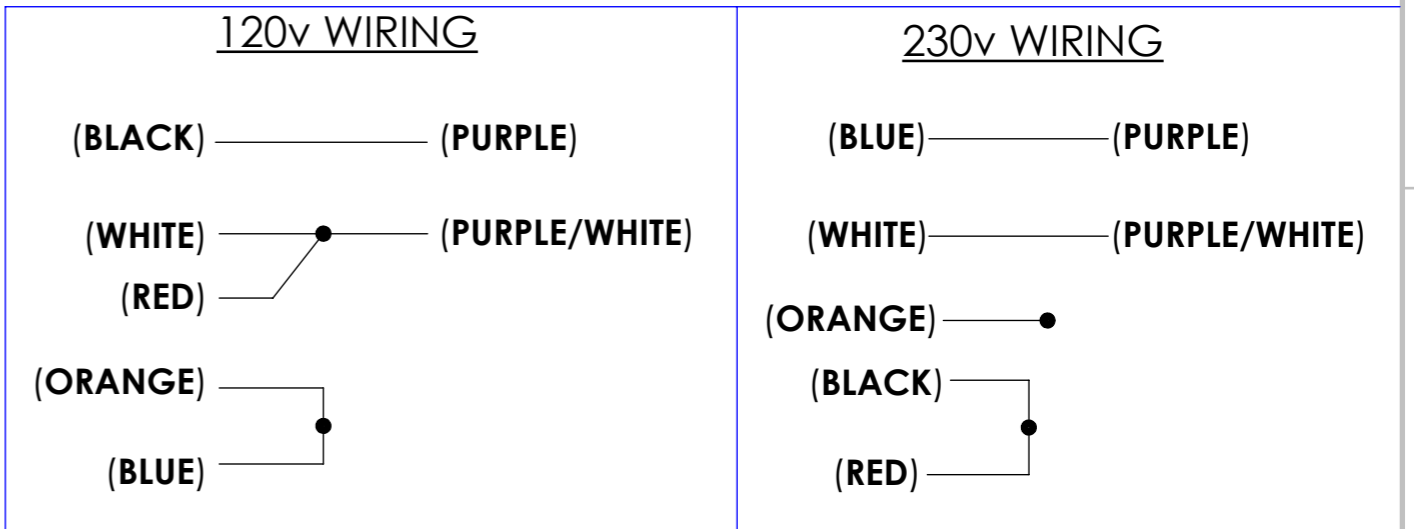

PROPRIETARY AND CONFIDENTIAL
THE INFORMATION CONTAINED IN THIS DRAWING IS THE SOLE PROPERTY OF SOUTHERN PRIDE DISTRIBUTING, LLC. ANY REPRODUCTION IN PART OR AS A WHOLE WITHOUT THE WRITTEN PERMISSION OF SOUTHERN PRIDE DISTRIBUTING, LLC IS PROHIBITED

Southern Pride Distributing, LLC
401 S. Mill Street
Alamo, TN 38001
Ph: 731-696-3175
Fax: 731-696-3180

TITLE: 120V / 230V CONVECTION FAN EXPLODED VIEW
MODEL: MLR-150 S/N: R150001 TO PRESENT
MLR-850 S/N: R8500001 TO PRESENT
UNLESS OTHERWISE SPECIFIED: DIMENSIONS ARE IN INCHES
TOLERANCES LINEAR: +/- 0.005" ANGULAR: +/- 0.1°
SIZE A3 DWG NO. SPEXPL-E105 REV 1
DO NOT SCALE DRAWING SCALE: 1:3 DRAWN BY: DAVE LEWSADER DATE: 1/29/2018 SHEET 1 OF 1